

CONTACT INFORMATION

- Website: www.supermicro.com
- General Information: marketing@supermicro.com
- Technical Support: support@supermicro.com
- Phone: +1 (408) 503-8000, Fax: +1 (408) 503-8008

FOR YOUR SYSTEM TO WORK PROPERLY, PLEASE DOWNLOAD APPROPRIATE

DRIVERS/IMAGES/USER'S MANUAL FROM THE LINKS BELOW:

- Manuals: <http://www.supermicro.com/support/manuals>
- Drivers & Utilities: <https://www.supermicro.com/wdl/driver/>
- Safety: http://www.supermicro.com/about/policies/safety_information.cfm

PACKAGE CONTENTS

- One Supermicro Motherboard
- One Quick Reference Guide



Motherboard Layout and Features

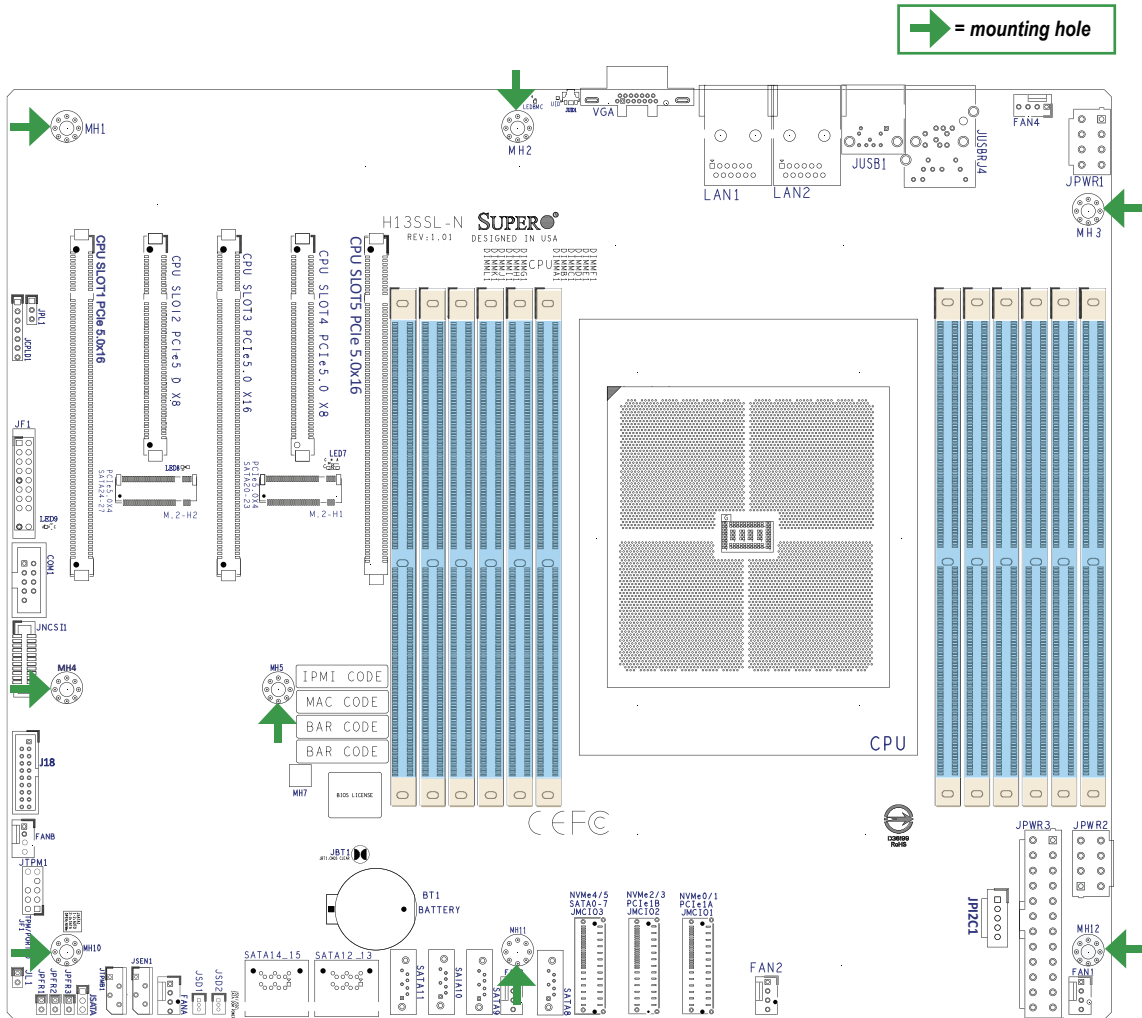

Rear I/O Panel Connectors

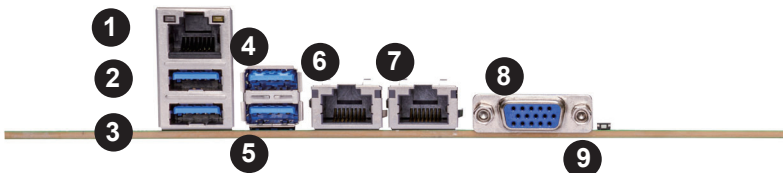

Rear I/O Ports			
#	Description	#	Description
1	IPMI LAN Port	6	LAN Port #2
2	USB 0 (3.0)	7	LAN Port #1
3	USB 1 (3.0)	8	VGA Port
4	USB 2 (3.0)	9	UID Switch & UID LED
5	USB 3 (3.0)		

Note: Graphics shown are for illustrative purposes only. Your components may or may not look exactly the same as drawings shown in this guide.

Jumpers, Connectors, and LED Indicators

Jumpers

Jumper	Description	Default Setting
UID SW	Unit ID Switch (push-button toggle switch ON/OFF)	Off
JBT1	CMOS Clear	Open (Normal)
JSATA1	Hybrid MCIO Select	Pins 1-2 (Auto)
JPL1	LAN Enable/Disable	Pins 1-2 (Enabled)

Connectors

Connector	Description
Battery (BT1)	Onboard Battery
COM1	Rear Panel COM Port #1
FAN1, 2, 3, 4, A, B	4-pin System/CPU Cooling Fan Headers
JF1	Front Control Panel
JSD1, JSD2	SATA DOM Power Connector
JTPM1	Trusted Platform Module/Port 80 Connector
SATA0-7	SATA 3.0 Ports 0-7 via MCIO3
SATA8-9	SATA 3.0 Ports
SATA10-11	SATA 3.0 Ports with SATA DOM Power
SATA12-13; 14-15	SATA 3.0 Ports 12-13; 14-15
JL1	Chassis Intrusion Header
JSEN1	Inlet Sensor Header
USB 0/1 (3.0)	Back Panel USB 3.0 Ports (USB0/1)
USB 2/3 (3.0)	Back Panel USB 3.0 Ports (USB2/3)
USB 4/5 (3.0)	Internal USB 3.0 Header (USB4/5)
JIPMB1	4-pin BMC External I2C Header (for an IPMI Card)
JPWR1, JPWR2	12V 8-pin CPU Core Power Supply Connector
JPWR 3	24-pin ATX Power Supply Connector
M.2-H1/M.2-H2	M.2 Slots
LAN1, LAN2	Back Panel LAN1, LAN2 Connectors
VGA	Back Panel VGA Port
NVMe 0/1; 2/3; 4/5	NVMe Slots 0~5
JPI2C1	Power Supply SMBus I²C Header
PCIe 1, 3, 5	Slot PCIe 5.0 x16
PCIe 2, 4	Slot PCIe 5.0 x8

LED Indicators

LED	Description	Status
UID_LED	UID LED	Solid blue: UID switched to ON, unit identified
LEDBMC	BMC Heartbeat LED	Green: Blinking (BMC normal) Green: Fast blinking (BMC initializing)
LED9	Power LED	On: Power On

Note:

- H13SSL-N: two RJ45, Broadcom BCM5720L 1GbE LAN ports
- H13SSL-NT: two RJ45, Broadcom BCM57416 10GbE LAN ports

Note: Refer to Chapter 1 of the User Manual for detailed information on jumpers, connectors, and LED indicators.

Memory and Processor Support

Memory Support

The H13SSL-N/H13SSL-NT supports up to 3 TB of ECC DDR5 4800 MT/s speed, RDIMM/LRDIMM/3DS memory in 12 slots.

DIMM Population Guide

	Channel											
	F1	E1	D1	C1	B1	A1	G1	H1	I1	J1	K1	L1
CPU1 & 1 DIMM						V						
CPU1 & 2 DIMM						V	V					
CPU1 & 4 DIMM				V		V	V		V			
CPU1 & 6 DIMM				V	V	V	V	V	V			
CPU1 & 8 DIMM		V		V	V	V	V	V	V	V		
CPU1 & 10 DIMM		V	V	V	V	V	V	V	V	V	V	
CPU1 & 12 DIMM	V	V	V	V	V	V	V	V	V	V	V	V

Processor Installation

The H13SSL-N/H13SSL-NT motherboard supports an AMD EPYC™ 9004 series processor with up to a 400 W TDP in an SP5 socket.

- 1 Use a Torx T20 screwdriver to loosen the screw holding down the force frame.

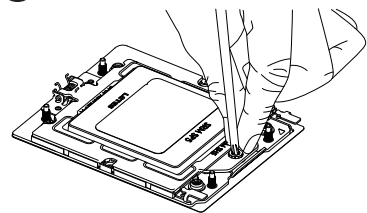

- 2 Raise the force frame and then the rail frame.

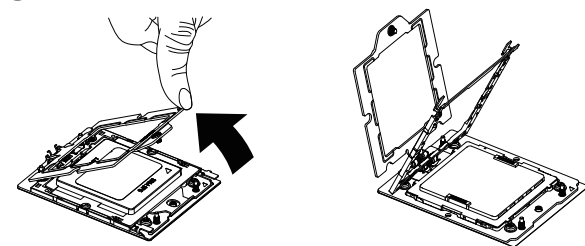

- 3 Remove the external cap and the PnP cover cap.

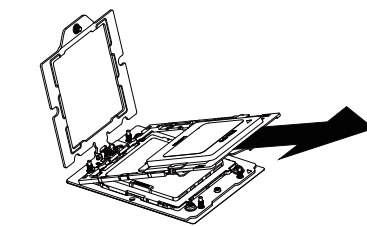

- 4 Insert the carrier frame/CPU package.
- 5 Lower and then secure the force frame with the screw shown in step 1 to 10.85~13.01 lbf-in.

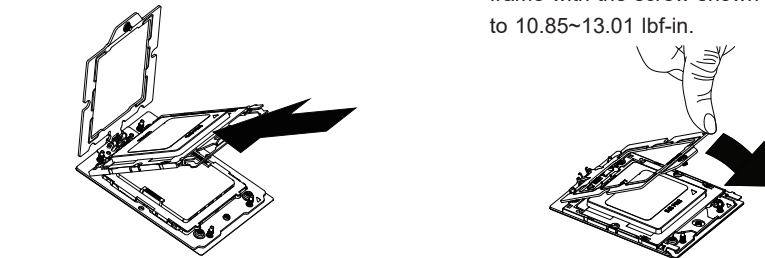

Note: Refer to Chapter 2 of the User Manual for detailed information on memory support and CPU/motherboard installation instructions.